

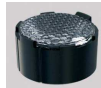

**DATA SHEET LINEAR LN05 LED LAMPS SERIES**

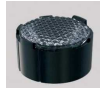

**Power LED lamp for surface supporting installation with on board lens**

- PCB made with Metal-Core (1,6mm thick) or CEM3
- 4 power LEDs series on board
- White LEDs colour temperatures available 3500K, 4000K, 5700K
- Custom realisation with coloured LEDs available on request
- Costant current power supply with 350mA, 500mA, 700mA external driver
- Room temperature 25°C
- Average lifetime 50.000 hours
- Five different lenses available
- Compliance with EN 62471:2008-09 group 1
- CE Marking

| Model                  | Maximum Power (W) | Available lenses  |   |  |   |   |
|------------------------|-------------------|---|---|--|---|---|
|                        |                   | 10°   | 18°   | 32°  | 49°   | 7°/53°  |
| <b>LN05xxx350xxxxx</b> | 5                 |   |   |  |   |   |
| <b>LN05xxx500xxxxx</b> | 7                 |  |  |  |  |  |
| <b>LN05xxx700xxxxx</b> | 10                |   |   |  |   |   |

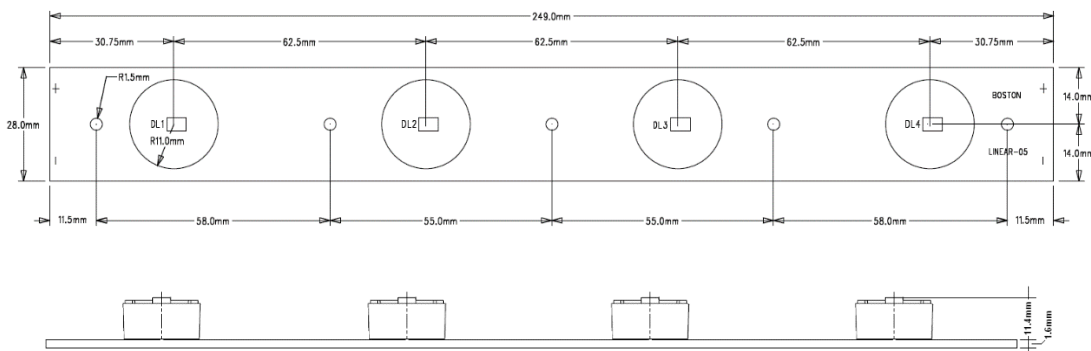

**For further information please ask us the complete product Data-Sheet**



IS A PRODUCT LINE UNDER THE OWNERSHIP OF BOSTON ELETTRONICA S.R.L.  
VIALE ORTLES, 80 - 20139 MILANO ☎ 02/55211283